



PITT-10-25-003

October 10, 2025

Project Number: 212C-PB-02688

Cecil Township Supervisors
3599 Millers Run Road
Cecil, Pennsylvania 15321

Subject: Notification as Required by PADEP
Intent to Submit a Water Management Plan Application
for the Withdrawal of Water Associated with Oil and Gas Exploration
Interconnection to 5D Field Services Southview Road Meter Vault
Supplied by Pennsylvania American Water Authority
Cecil Township, Washington County, Pennsylvania

Dear Supervisors:

Tetra Tech, Inc. (Tetra Tech) is submitting this notification letter on behalf of Range Resources – Appalachia LLC (Range), who intends to submit to the Pennsylvania Department of Environmental Protection (PADEP) a Water Management Plan (WMP) application for a new interconnected water source, 5D Field Services Southview Road Meter Vault Supplied by Pennsylvania American Water Authority in Cecil Township, Washington County, Pennsylvania. The water withdrawal location is shown on the attached map.

Information on the WMP and the proposed withdrawal may be obtained from and comments should be submitted within 30 days to the PADEP office located at:

Pennsylvania Department of Environmental Protection
Bureau of Oil and Gas Management
400 Waterfront Drive
Pittsburgh, PA 15222

If you have any questions regarding this submittal or require additional information, please contact Karl Matz of Range at (570) 772-4389 or me at (412) 921-8984.

Sincerely,

A handwritten signature in blue ink that reads 'Corey A. Rich'.

Corey A. Rich
Tetra Tech, Inc.

Enclosure – Site Location Map

cc: Karl Matz – Range (electronic copy)
Alex Alvarez – Range (electronic copy)
File 212C-PB-02688 (1 copy)

Tetra Tech, Inc.
661 Andersen Drive, Foster Plaza 7, Suite 500, Pittsburgh, PA 15220
Tel +1.412.921.7090 Fax +1.412.921.4040 | tetrattech.com

Notes:

- 1) Topographic map provided by ESRI's ArcGIS Online USA Topo Maps map service (© 2013 National Geographic Society, i-cubed).
- 2) Quadrangle(s) displayed: Midway, Canonsburg.

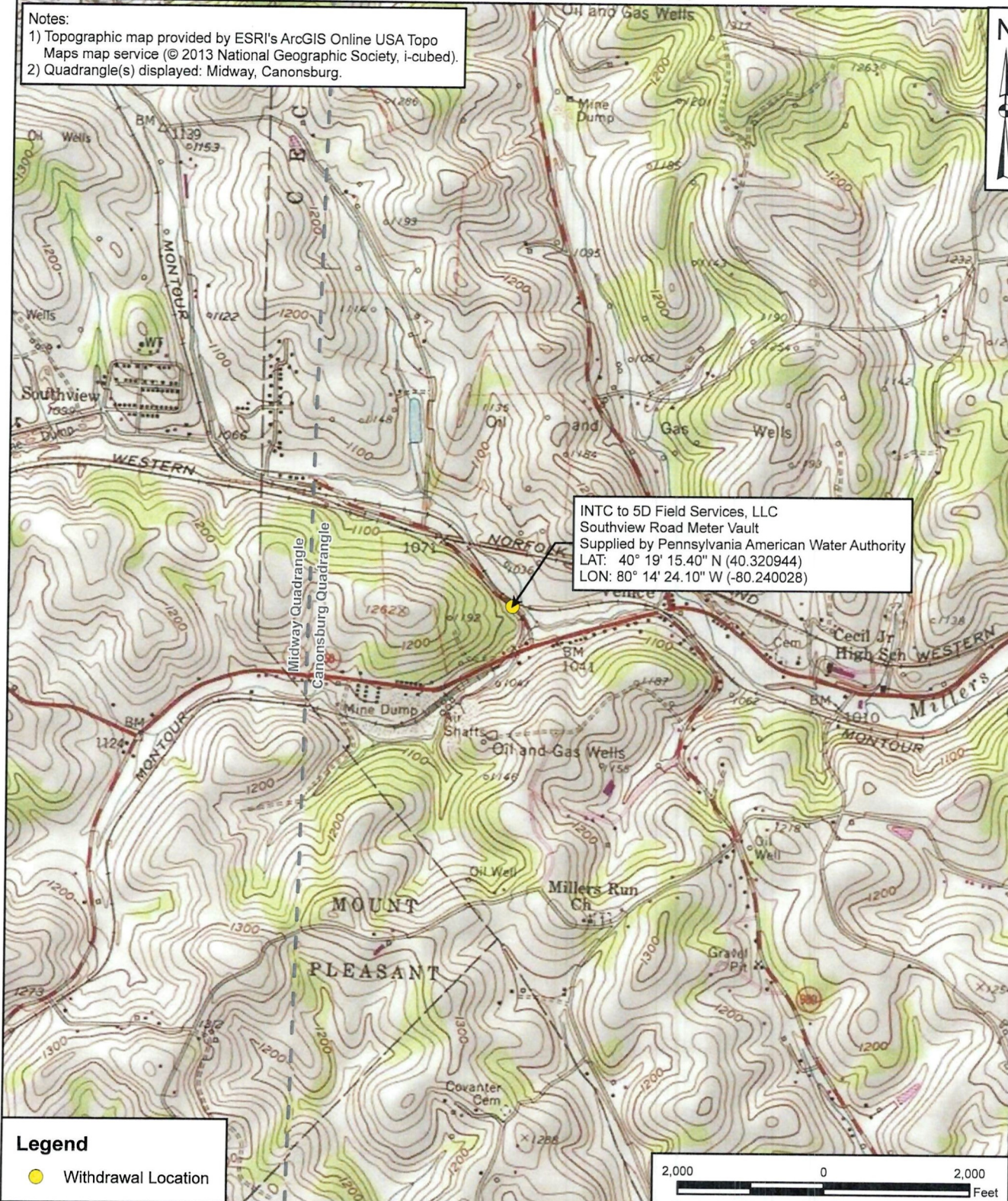

INTC to 5D Field Services, LLC
 Southview Road Meter Vault
 Supplied by Pennsylvania American Water Authority
 LAT: 40° 19' 15.40" N (40.320944)
 LON: 80° 14' 24.10" W (-80.240028)

Legend

- Withdrawal Location



TETRA TECH

USGS PROJECT LOCATION MAP
 INTC TO 5D FIELD SERVICES, LLC SOUTHVIEW METER VAULT
 SUPPLIED BY PENNSYLVANIA AMERICAN WATER AUTHORITY

RANGE RESOURCES - APPALACHIA, LLC
 CECIL TOWNSHIP, WASHINGTON COUNTY, PENNSYLVANIA

DRAWN BY: T. TEAFORD 10/08/2025
 CHECKED BY: J. LANGE 10/08/2025
 APPROVED BY: C. RICH 10/08/2025

CONTRACT NUMBER: 212C-PB-02688

FIGURE NUMBER

1

REV

0