



A FULL-SERVICE CIVIL ENGINEERING FIRM

 100 McMorris Road
Pittsburgh, PA 15205

 412-921-4030

 GatewayEngineers.com

FEDERAL EXPRESS

Cecil Township Supervisors
3599 Millers Run Road
Cecil, PA 15321

April 21, 2025

C-17523-0918

Subject: Act 14, 67, 68, 127 Notification as Required by PADEP
Intent to Submit a Notice of Intent for Coverage under General Permit Registration (GP-5)
Range Resources – Appalachia, LLC – **Augustine to Conner Samuel Temporary Waterline**
Cecil Township, Washington County, Pennsylvania
Project Contact: Karl Matz, Range Resources - Appalachia, LLC (724) 873-3090

Dear Supervisors:

This notice, under the requirements of Act 14, 97 P.S. § 510-5, is to advise you that Range Resources – Appalachia, LLC intends to submit for Coverage under a General Permit 5 for utility line stream and wetland crossings associated with Oil and Gas Exploration, Production, Processing, or Treatment Operations or Transmission Facilities from the Pennsylvania Department of Environmental Protection (PADEP), for Temporary Waterline located in Cecil Township, Washington County, Pennsylvania. A topographic map showing the approximate location of the project site and stream and wetland crossings locations is enclosed.

Also enclosed is a copy of the General Permit Registration form. If you wish to submit comments in regard to land use aspects of this project for DEP to consider, you must respond within 30 days from the receipt of this letter to the DEP Permitting and Technical Services Section at **Pennsylvania Department of Environmental Protection, Bureau of Oil and Gas Management, 400 Waterfront Drive, Pittsburgh, Pennsylvania 15222**. If there are no land use comments received by the end of the comment period, DEP will assume that there are no substantive land use conflicts and proceed with the normal application review process.

If questions concerning the proposed project should arise, contact Karl Matz of Range Resources –Appalachia, LLC at (724) 873-3090.

Sincerely,
THE GATEWAY ENGINEERS, INC.

Adam Greathouse

Adam L. Greathouse

FULL-SERVICE CIVIL ENGINEERING

ASSET MANAGEMENT • ENVIRONMENTAL • GEOTECHNICAL
LAND DEVELOPMENT • MUNICIPAL • STRUCTURAL • SURVEYING • TRANSPORTATION

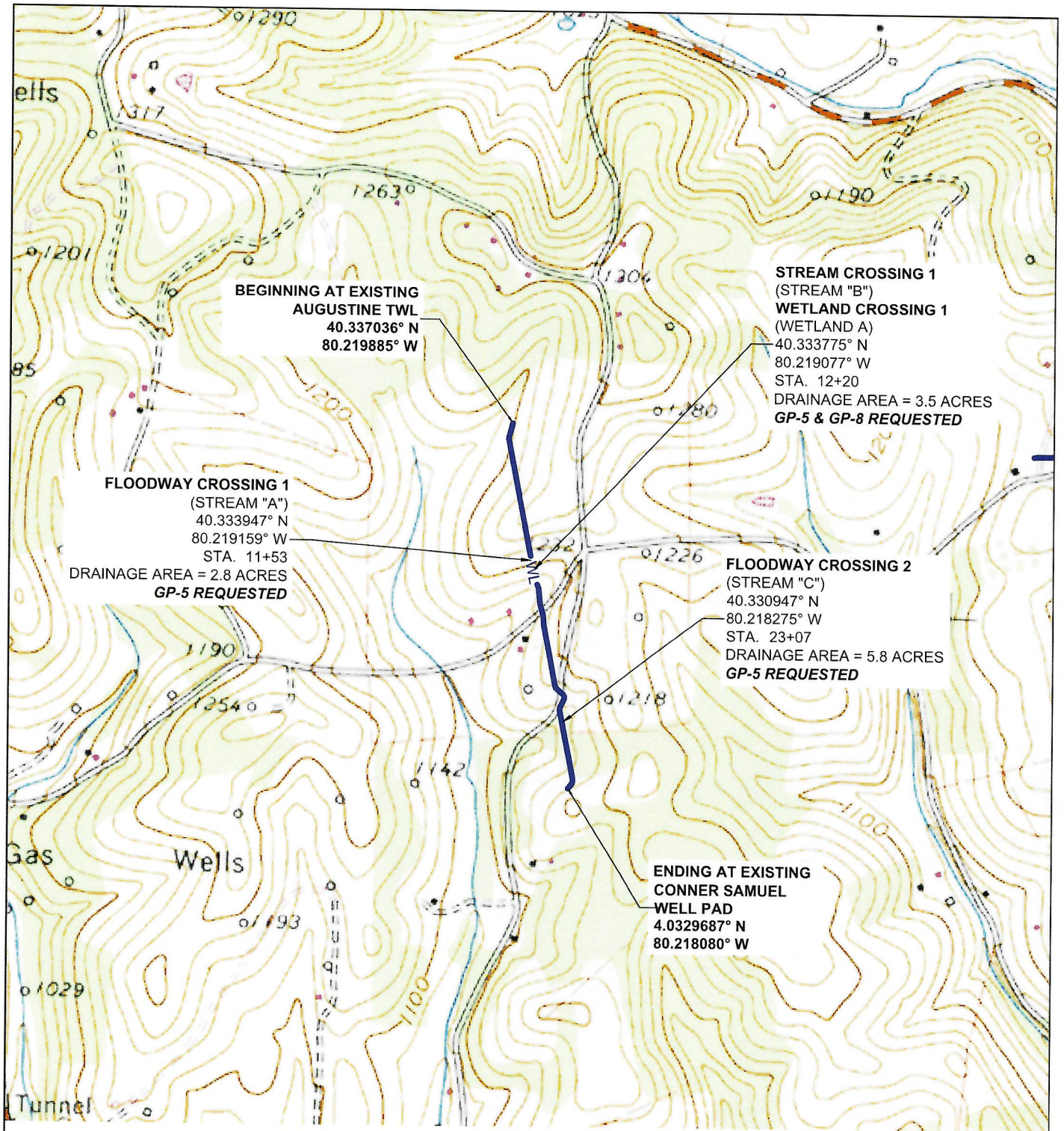

NORTH

SITE LOCATION MAP
CANNONSBURG QUADRANGLE
SCALE: 1" = 1000'

NOTE:

THE ALIGNMENT AND LOCATION OF THE PROPOSED PIPELINE BETWEEN STREAM CROSSINGS IS APPROXIMATE AND IS SUBJECT TO CHANGE AS NEEDED TO ALLOW FOR UNFORESEEN CIRCUMSTANCES. ALL PROPOSED RELOCATIONS WILL BE ENVIRONMENTALLY SCREENED TO ENSURE THAT NO ADDITIONAL AQUATIC FEATURES ARE IMPACTED. THE LOCATIONS OF ALL CHAPTER 105 REGISTRATIONS WILL NOT BE CHANGED.

USGS SITE
 LOCATION MAP
 Project Number: 17523-0918
 Drawing Code: 17523-0918
 Date Issued: MAR 2025
 Index Number: -
 Drawn By: JMA
 Checked By: AWS
 Project Manager: AWS
USGS

AUGUSTINE TO CONNER SAMUEL TWL
 CECIL TOWNSHIP
 WASHINGTON COUNTY, PA

PREPARED FOR:
RANGE RESOURCES - APPALACHIA, LLC
 3000 TOWN CENTER BOULEVARD
 CANNONSBURG, PA 15317

Date	No	REVISION RECORD
-	01	-
-	02	-
-	03	-
-	04	-
-	05	-
-	06	-
-	07	-
-	08	-



GATEWAY®

The Gateway Engineers, Inc.
 Full-Service Civil Engineering & Surveying
 Pittsburgh, PA

gatewayengineers.com 855-634-9284



COMMONWEALTH OF PENNSYLVANIA
DEPARTMENT OF ENVIRONMENTAL PROTECTION
BUREAU OF WATERWAYS ENGINEERING AND WETLANDS

CHAPTER 105 WATER OBSTRUCTIONS AND ENCROACHMENT GENERAL PERMIT REGISTRATION

SECTION A. APPLICANT INFORMATION					
Applicant's Name / Client Range Resources - Appalachia, LLC		DEP Client ID# (if known) 141142		Employer ID# (EIN) 34-1902948	
Client Information - Please select Client Type / Code from drop down box under the correct entity shown below. (or may be written in) ↓					
Government		Non-Government		Individual	
		LLC Ltd Liability Company			
Mailing Address 3000 Town Center Boulevard			City Canonsburg		State PA
					ZIP + 4 15317
Contact Person – Last Name Matz		First Karl	MI MI	Suffix P.E.	Telephone (724) 873-3090
Email Address kmatz@rangeresources.com					
SECTION B. CONSULTANT INFORMATION (If applicable) <input type="checkbox"/> N/A					
Contact Person – Last Name Gephart		First Adam	MI MI	Suffix MI	Consultants Title Project Manager
					Consulting Firm The Gateway Engineers, Inc.
Mailing Address 100 McMorris Road			City Pittsburgh		State PA
					ZIP + 4 15205
Telephone (412)) 409-2309		Fax ()			Employer ID# (EIN) 25-1006946
Email agephart@gatewayengineers.com					
SECTION C. PROJECT INFORMATION					
Project / Site Name Augustine to Conner Samuel Temporary Waterline				DEP Site ID# (if known or leave blank)	
Client Relationship - Please select Site-to-Client Relationship / Code from drop down box to the right. (or may be written in) →				Double-click on shaded area below to select correct Site-to-Client Relationship / Code ↓ OWN Owner	
County Washington	Municipality Cecil	<input type="checkbox"/> City <input type="checkbox"/> Borough <input checked="" type="checkbox"/> Township		Note: Municipal & County Notification is Required	
Site Location / Address Linear Project			City McDonald		State PA
					ZIP + 4 15057
Latitude: 40.333275 _____ Longitude: -80.218934 _____					

SECTION D. REGISTRATION CHECKLIST AND REQUIREMENTS

PLEASE PLACE AN "X" NEXT TO EACH ITEM (1-11) TO ENSURE IT IS COMPLETED AND/OR PROVIDED. Unless otherwise specified, **ALL ITEMS** are **required** to ensure a complete Registration package. See GP Registration Instructions (3150-PM-BWEW0500) for additional details.

1. **Registering a General Permit (GP):** Check all GPs which you are registering. Enter project details to calculate applicable fee. See Chapter 105 Fee Calculation Worksheet (3150-PM-BWEW0553) for additional details

APPLICANT ENTRY					DEP ONLY
Federal, State, county or municipal agency or municipal authority:				<input type="checkbox"/> EXEMPT from fees	<input type="checkbox"/>
<input type="checkbox"/> GP-1	Fish Habitat Enhancement Structures	Per Project	\$ 50 =	\$ _____	<input type="checkbox"/>
<input type="checkbox"/> GP-2	Small Docks and Boat Launching Ramps	Per Dock / Ramp _____ (#) x	\$ 175 =	\$ _____	<input type="checkbox"/>
<input type="checkbox"/> GP-3	Bank Rehabilitation, Bank Protection and Gravel Bar Removal	Per Project _____ (#) x	\$ 250 =	\$ _____	<input type="checkbox"/>
<input type="checkbox"/> GP-4	Intake and Outfall Structures	Per Structure _____ (#) x	\$ 200 =	\$ _____	<input type="checkbox"/>
<input checked="" type="checkbox"/> GP-5	Utility Line Stream Crossings	Utility Lines <u>3</u> (#) x Per Crossing <u>1</u> (#) x	\$ 250 =	\$ <u>750</u>	<input type="checkbox"/>
<input type="checkbox"/> GP-6	Agricultural Crossings and Ramps	Per Crossing / Ramp _____ (#) x	\$ 50 =	\$ _____	<input type="checkbox"/>
<input type="checkbox"/> GP-7	Minor Road Crossings	Per Crossing _____ (#) x	\$ 350 =	\$ _____	<input type="checkbox"/>
<input type="checkbox"/> GP-8	Temporary Road Crossings	Per Crossing _____ (#) x	\$ 175 =	\$ _____	<input type="checkbox"/>
<input type="checkbox"/> GP-9	Agricultural Activities	Per Project	\$ 50 =	\$ _____	<input type="checkbox"/>
<input type="checkbox"/> GP-10	Abandoned Mine Reclamation	Per Project	\$ 500 =	\$ _____	<input type="checkbox"/>
<input type="checkbox"/> GP-11	Maintenance, Testing, Repair, Rehabilitation, or Replacement of Water Obstructions and Encroachments		\$ 750 =	\$ _____	<input type="checkbox"/>
	<input type="checkbox"/> Temporary Disturbance (\$400/0.1ac)	_____ acres x	\$4,000 =	+ \$ _____	<input type="checkbox"/>
	<input type="checkbox"/> Permanent Disturbance (\$800/0.1ac)	_____ acres x	\$8,000 =	+ \$ _____	<input type="checkbox"/>
GP-11 subtotal				= \$ _____	<input type="checkbox"/>
<input type="checkbox"/> GP-15	Private Residential Construction in Wetlands		\$ 750 =	\$ _____	<input type="checkbox"/>
	<input type="checkbox"/> Temporary Disturbance (\$400/0.1ac)	_____ acres x	\$4,000 =	+ \$ _____	<input type="checkbox"/>
	<input type="checkbox"/> Permanent Disturbance (\$800/0.1ac)	_____ acres x	\$8,000 =	+ \$ _____	<input type="checkbox"/>
GP-15 subtotal				= \$ _____	<input type="checkbox"/>
TOTAL OF ALL GP FEES				= \$ <u>750</u>	<input type="checkbox"/>

APPLICANT ENTRY		DEP ONLY
2. Location Map with project site marked: (Note: PNDI Search Receipt Map is sufficient)	<input checked="" type="checkbox"/>	<input type="checkbox"/>
3. Color Photographs showing proposed activity and resource area, as recommended in the instructions.	<input checked="" type="checkbox"/>	<input type="checkbox"/>
4. Project Description including proposed impacts and potential coordination with the Federal Energy Regulatory Commission (FERC) or a separate/individual 401 Water Quality Certification.	<input checked="" type="checkbox"/>	<input type="checkbox"/>
5. Site Plan & Other Drawings showing all proposed project activities. <i>Sample Drawings are available.</i> NOTE - For registrations of a GP-7 or GP-11, some activities for use by the general public may require a Professional Engineer Seal and Certification. See <u>GP Registration Instructions</u> for specific details.	<input checked="" type="checkbox"/>	<input type="checkbox"/>
6. Chapter 102 (Erosion and Sediment Control): Select ONE option to indicate how compliance is being obtained. See <u>GP Registration Instructions</u> for more information.		
a. For GP-9: Has a Conservation Plan been approved by the county conservation district?	<input type="checkbox"/>	<input type="checkbox"/>
b. For GP-11: The E&S Plan is attached.	<input type="checkbox"/>	<input type="checkbox"/>
c. For Oil & Gas activities: The E&S Plan is attached OR a separate E&S permit (ESCGP) has been submitted.	<input checked="" type="checkbox"/>	<input type="checkbox"/>
d. All Other GPs: Will obtain an approved E&S Plan prior to commencement of construction.	<input type="checkbox"/>	<input type="checkbox"/>
7. Changes in Waterway Opening and Registration of Multiple Structures: Is this a GP-11? <input type="checkbox"/> Yes <input checked="" type="checkbox"/> No If Yes, provide the information below:		
a. <u>Bridge Or Culvert Replacement Projects or Projects That Change the Waterway Opening</u> form (3150-PM-BWEW0552B) or equivalent.	<input type="checkbox"/>	<input type="checkbox"/>
b. Registrations of multiple structures: <u>Project Inventory</u> form (3150-PM-BWEW0552A) or equivalent.	<input type="checkbox"/>	<input type="checkbox"/>
8. Pennsylvania Natural Diversity Inventory (PNDI): <u>PNDI Search Receipt</u> AND clearance letters. NOTE - Concurrent review does not apply to Chapter 105 GPs. See <u>GP Registration Instructions</u> for more information.	<input checked="" type="checkbox"/>	<input type="checkbox"/>
9. Wetlands: Are wetlands present at the project site? <input checked="" type="checkbox"/> Yes <input type="checkbox"/> No If Yes, provide the information below:		
a. A wetland delineation report following the method as detailed in the <u>GP Registration Instructions</u> .	<input checked="" type="checkbox"/>	<input type="checkbox"/>
b. Method to provide <u>Compensatory Mitigation</u> for impacts which require compensatory mitigation, as detailed in the <u>GP Registration Instructions</u> .	<input type="checkbox"/>	<input type="checkbox"/>
10. Proposed Impacts: General Permit Aquatic Resource Impact Table form (3950-PM-BWEW0560) or equivalent.	<input checked="" type="checkbox"/>	<input type="checkbox"/>
11. Submerged Lands of the Commonwealth: In certain situations, a Submerged Lands License Agreement (SLLA) is required, but not all waters are Submerged Lands of the Commonwealth. The final determination is made by DEP. See <u>GP Registration Instructions</u> for more information. Select ONE option to indicate how an SLLA is being addressed.		
a. I believe an SLLA is required and have attached plans including the facility area information. OR	<input type="checkbox"/>	<input type="checkbox"/>
b. I believe an SLLA is not required or I am unsure.	<input checked="" type="checkbox"/>	<input type="checkbox"/>

SECTION E. CERTIFICATION

I certify under penalty of law that the information provided in this permit registration is true and correct to the best of my knowledge and information and that I possess the authority to undertake the proposed action. I am aware that there are significant penalties for submitting false information, including the possibility of fine and imprisonment for knowing violations. (If any of the information and/or plans is found to be in error, falsified, and/or incomplete, this authorization/verification may be subject to modification, suspension, or revocation in accordance with applicable regulations.) I further certify that this project complies with all the conditions of the general permit.

Applicant / Owner Signature

Date _____

Typed / Printed Name

This General Permit shall not be effective until the owner has had their E&S Plan reviewed by the appropriate Regional Office or District, and, where required, obtained an SLLA from DEP.

Please provide a copy of the Registration form to the Municipality & County in which the work will be performed.
Proof of receipt is not required to be provided to DEP.

**THIS ACKNOWLEDGED COPY OF THIS GENERAL PERMIT REGISTRATION PACKAGE AND THE E&S PLAN
MUST BE AVAILABLE AT THE PROJECT SITE DURING CONSTRUCTION.**

STOP! THE REMAINDER OF THIS FORM WILL BE COMPLETED BY DEP STAFF.

SECTION F. DECISION / DISPOSITION – COMPLETED BY DEP

Decision Review:

DEP / District Reviewer Signature

GP _____

GP _____

GP _____

Reviewer's Typed / Printed Name

Disposition Status:

☐ **ACKNOWLEDGED**

SLLA Required

Date _____

☐ Yes Attached ☐ No

☐ **ELIGIBILITY DEFICIENCY ***

Date _____

☐ **EXTENSION REQUEST ***

Date _____

☐ **WITHDRAWN**

Date _____

Comments

* If the GP registration information is incomplete/deficient a copy of this registration form and requested additional information **must be re-submitted within 60 calendar days** unless extended by the extension date listed above. See GP Registration Instructions for more information

FEDERAL AUTHORIZATION:

☐ As proposed, this General Permit does not require Federal Authorization.

☐ Non-reporting PASPGP verification / authorization attached.

☐ Reporting * – A copy of this General Permit registration package has been sent to the U.S. Army Corps of Engineers. Separate federal authorization may be required.

* If the reporting box is checked **you do not have Federal authorization** for this project and **such authorization may be required prior to starting your project**. In accordance with procedures established with the U.S. Army Corps of Engineers, you will be contacted directly by the Corps regarding Federal Authorization.